

CYNTEC CO., LTD.

乾坤科技股份有限公司

HMP1580 Series

Mechanical dimensions

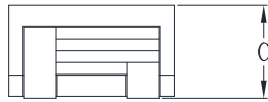
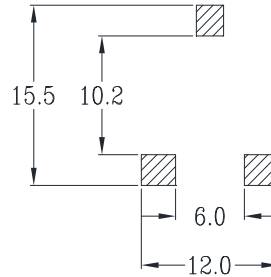
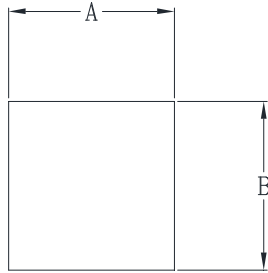

Suggested PWB Layout

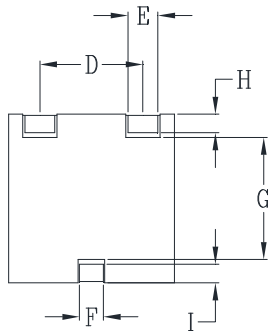

UNIT : mm
 A = 14.5±0.4
 B = 14.5±0.4
 C = 7.5±0.5
 D = 9.0
 E = 2.6±0.2
 F = 2.1±0.2
 G = 10.5
 H = 1.8±0.2
 I = 1.5±0.2

Electrical Characteristics: @25°C, 100kHz, 1V

Delta P/N	L ¹ (uH)	Li (uH) TYP.	DCR (mΩ) MAX	Isat ² (A)		Ir ³ (A)
				25°C	100°C	
HMP1580-0R7	0.7	0.5	1.22	55	45	54
HMP1580-1R5	1.5	1.1	1.5	30	25	29

1. Tolerance of inductance : ± 15%
2. Isat is the DC current which causes the inductance drop to Li.
3. Ir is the DC current which causes the surface temperature of the part increase less than 45 °C.
4. Operating temperature: -40°C to 150°C (Self-temperature rise included).